

---

## TRANSFER & SHARE

---

*This documentation is provided or made accessible "AS IS" and "AS AVAILABLE" and without condition, endorsement, guarantee, representation, or warranty of any kind and IDimager Systems assumes no responsibility for any typographical, technical, or other inaccuracies, errors, or omissions in this documentation. IDimager System reserves the right to periodically change information that is contained in this documentation.*

### Introduction

Photo Supreme is “Digital Asset Management” software. Photo Supreme makes it possible to manage your image files by categorizing them. It will categorize the files based on the available details of the file, this includes technical photo details, but also the location of the file on disk, etc. Apart from those properties you can add tags to the images, enrich the files with descriptions, or add custom information.

One of the biggest advantages when using DAM software is the simplicity to search for images, to organize them in portfolios, and to catalog them with tags and descriptions. Of course, you also want to use the information that you put into the managing of your images. One of such uses is to share your files with others. With Photo Supreme you can share your images directly to email, folders, FTP, or photo sharing services like Flickr, SmugMug and others.

This manual describes the concept of using Transfer in Photo Supreme and how you can put that to use for your images.

### Sharing Concept

Sharing with Photo Supreme allows you to quickly share images with friends, customers, or for your own purpose. You define how you want the transfer to occur and store that as a Transfer Profile. Then Photo Supreme can use such a profile to handle your images and send them to a target service. In general, you will not need to “prepare” your images up-front. Photo Supreme will create temporary downsized copies, add, or remove metadata as you prefer, add on image watermarks if needed, and then send those out to the service.

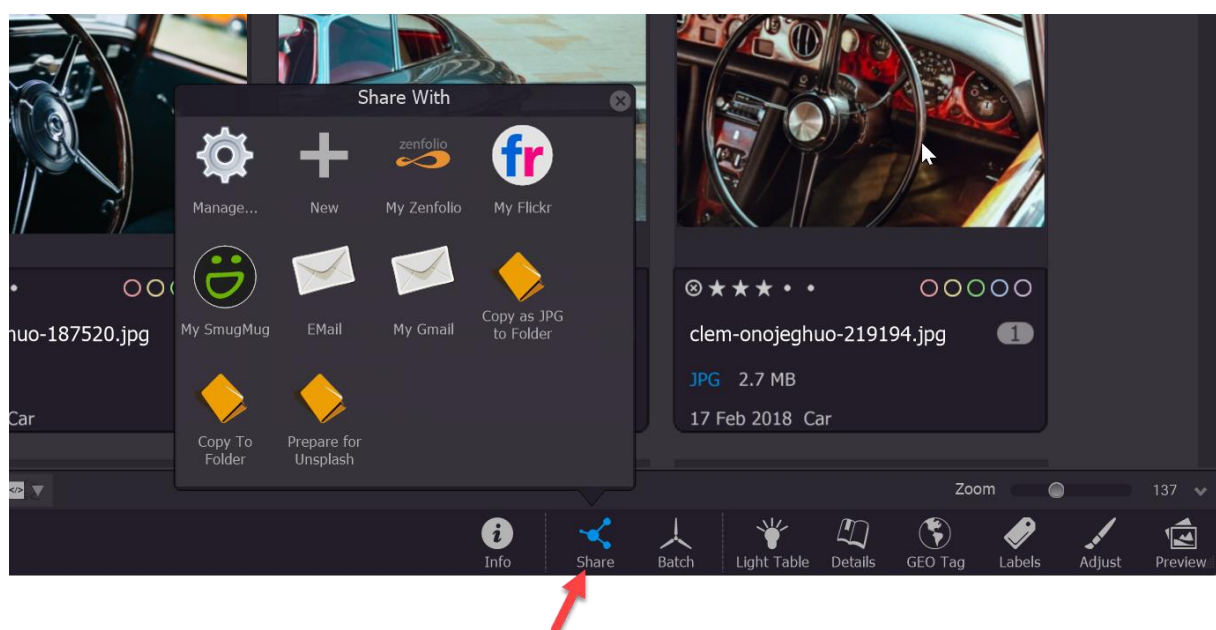

Services supported by Photo Supreme’s Share feature are (trademarks may apply where applicable):

- Flickr – <https://www.flickr.com/>
- SmugMug – <https://www.smugmug.com/>
- ZenFolio - <https://www.zenfolio.com/>
- Email - *either with the embedded SMTP client or with your Favorite email client*
- FTP - *File Transfer Protocol*
- Folder – *A folder on one of your hard drives*

## Working with Transfer Profiles

As explained above, a Transfer Profile contains information on how you want Photo Supreme to handle images for a target service. Photo Supreme comes with a few predefined profiles, but you can also create your own. To create a new profile, first click the Share button from the Command Bar below the thumbnails.

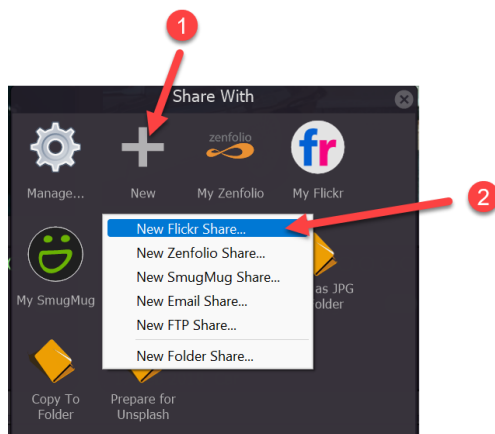

You can then name your profile. Give it a name that is meaningful for you. It is also the name that will be used below the icons in the Share callout. Then click the OK button.

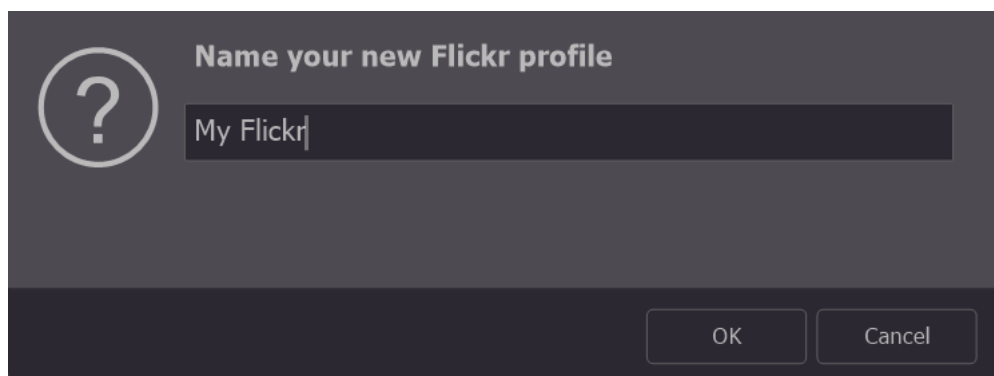

You can now define how the profile should behave. The Profile is organized in sections:

**Authentication and Location**

Here you can connect to the service and specify the target location to be used by the profile. Both are optional. If you do not authenticate in the profile, then you will be asked to authenticate when you are using the profile. And if you do not select a target location then that too will be asked when using the profile.

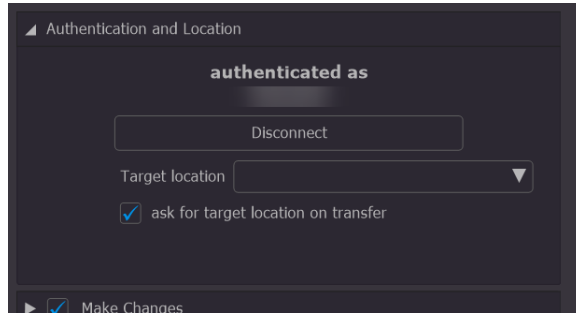

**Make Changes**

In this section you can define if changes should occur and, if so, how it should down or upsize.

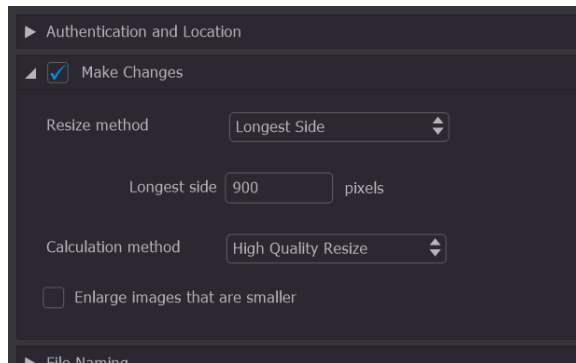

**Note:** Tick the checkbox to use sizing or not. When you do not use sizing (no tick) then that indicates that the original image will be sent out. Other adjustment sections in the profile (like metadata settings etc.) then are not available. If you want to send out an original sized image but with adjustments, then enable sizing and set the resize method to *Keep Original Size*.

**File Naming**

Use this section to define the target naming scheme for your images to be transferred.

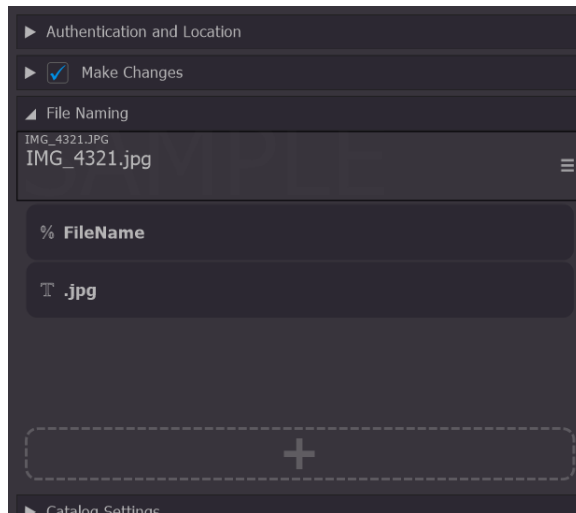

### Catalog Settings

This section allows you to select a specific version to be used for transfer.

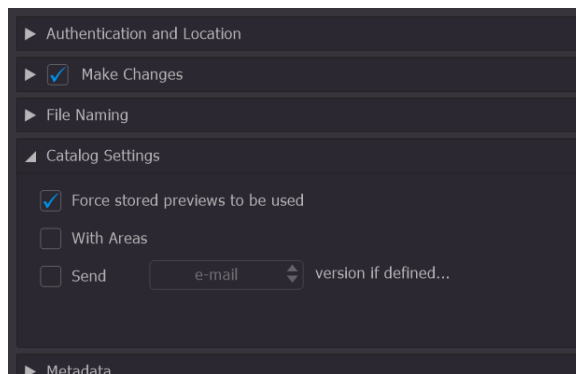

### Metadata

Use this section to specify the way to handle metadata for images to be transferred with this profile.

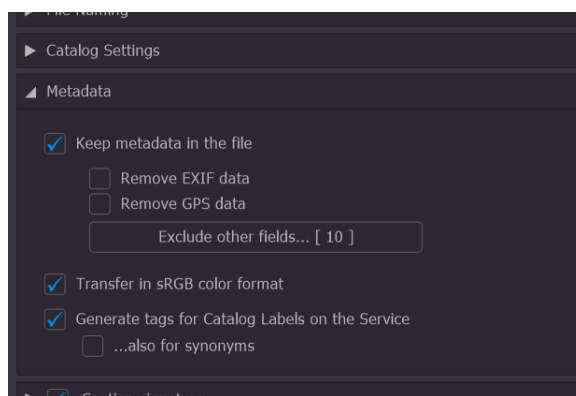

### Caption signature

In this section you can select up to two caption signatures that should be written as a watermark text on the image.

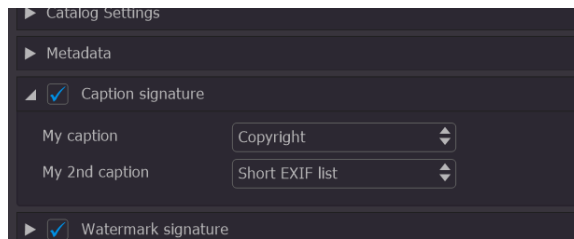

### Watermark signature

This section is typically used to add image watermarks to your images. This could be a Logo graphic or any other graphic.

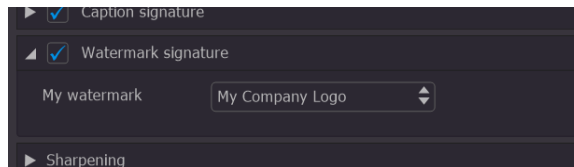

### Sharpening and Details

Use the Sharpening section to specify the level of sharpening to apply to the transferred image. Use the Details section to enter additional info about the profile.

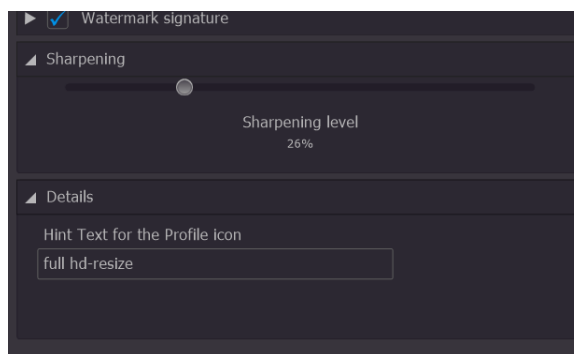

Once you have your Profile configured the way you want it to then click the OK button at the bottom to say it. Your profile will then appear in the Share Callout, ready to be used.

You can change your profile by right clicking on it and then select “Details...”. That is also where you can rename the profile or make a duplicate copy of it.

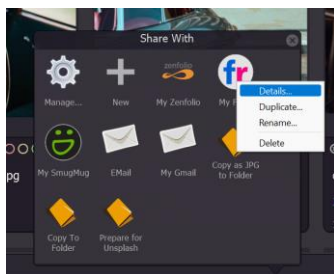

### Using a Share Profile

You can use any Share profile to send out a selection of images. Flickr profiles can also be used to fully synchronize a Portfolio with the Flickr service. More about that later.

### Sharing individual images

Sharing individual images with is done as follows:

1. Select the images that you want to share.
2. Click the Share button from the Action Bar.
3. Choose your Share profile.

The Share process will not alter your original files. Photo Supreme will create temporary copies of your images where needed and so you do not have to pre-handle your images to prepare them for sharing.

If your profile is configured with Authentication and a Target Location (for instance a folder or an album) then the images are transferred instantly. If your profile is configured without authentication or to prompt for a Target Location, then at this point you can authenticate and/or select the Target location.

### Synchronizing a Portfolio

In the previous section you learned how to transfer individual images to a target location. When you are using Flickr then Photo Supreme can also fully synchronize a Portfolio with Flickr. Photo Supreme can also so a full synchronize with a Folder profile, meaning that where a Flickr profile is used in this chapter, you can also use a Folder profile.

A Portfolio is a set of collections, and each collection can contain images and/or sub collections. A Portfolio is typically used to collect images together. For instance: you can create a portfolio for your Modelling photos with a collection per model that you work with and each collection only has the best shots of that model. Another sample is a Vacations portfolio with collections with the best picks of that trip.

The advantage of Syncing is that Photo Supreme will be leading and changes that you make are uploaded to Flickr which images that you have not touched remain untouched on Flickr. Only the needed data is uploaded. New collections, replaced collections, new images in a collection, deleted images from a collection, will all be synchronized with Flickr.

A few caveats that you should be aware of when synchronizing with Flickr. First: The number of hierarchical collection levels is unlimited in Photo Supreme, but Flickr only supports up to 5 nested levels. Only the first 5 levels will return on Flickr. Second: In Photo Supreme, each collection can contain images *and* sub collections, but on Flickr, a collection with sub collections cannot contain images also.

Now, let us get started. My first recommendation is to create a dedicated Flickr portfolio that will contain collections with every image that you want on the Flickr website. To do so, open the Portfolios section by selecting it from the Catalog Bar. Create a new portfolio by clicking the link “New portfolio”.

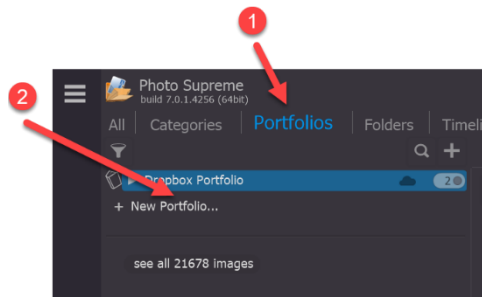

Now create a first Collection by selecting the portfolio and click the + button again. Then select to add a new Collection. Give it a meaning full name. Here is a screenshot of how I want to organize my images on Flickr.

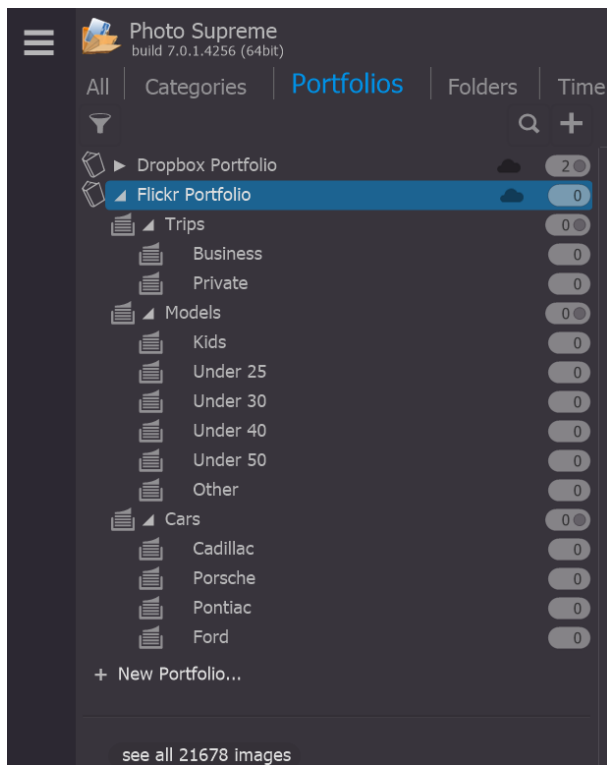

Now that the framework of my content is ready, I can start collecting images into the collections.

Find the images anywhere in the catalog and press Ctrl+Shift+B or Cmd+Shift+B to add a selection of images to a portfolio collection.

I am not placing all my pictures on Flickr, but only my “best off” images find their way to Flickr. But of course, Flickr offers enough disk space (even in a Free account) and so you can also upload everything if you like. In general people do not like to browse through thousands of images and so to keep it interesting (I hope), I only share what I consider my best shots of that subject.

After you have filled your entire portfolio with images, you are ready to start the sync. As explained above, only changes since the previous sync are uploaded. If this is the first time that you synchronize, then all existing images will be uploaded. Best to start with a clean Flickr account.

To start the synchronize process, you first need to have a Flickr or a Folder Share profile. If you do not have such a profile yet, then create one by clicking the Share button below the thumbnails. After you have created at least one Flickr or Folder Share profile, then you will see a Cloud-icon for every portfolio.



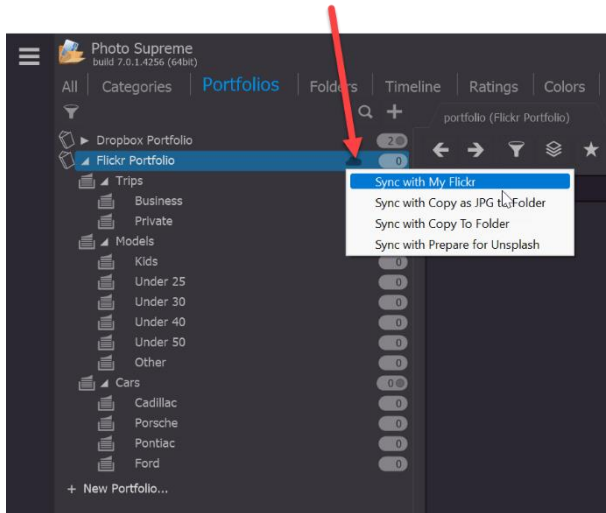

Click that icon to open the Sync menu. That will list the Flickr and Folder profiles that are available for full synchronization.